

Belair National Park

Main Entrance - Shared Use Trails

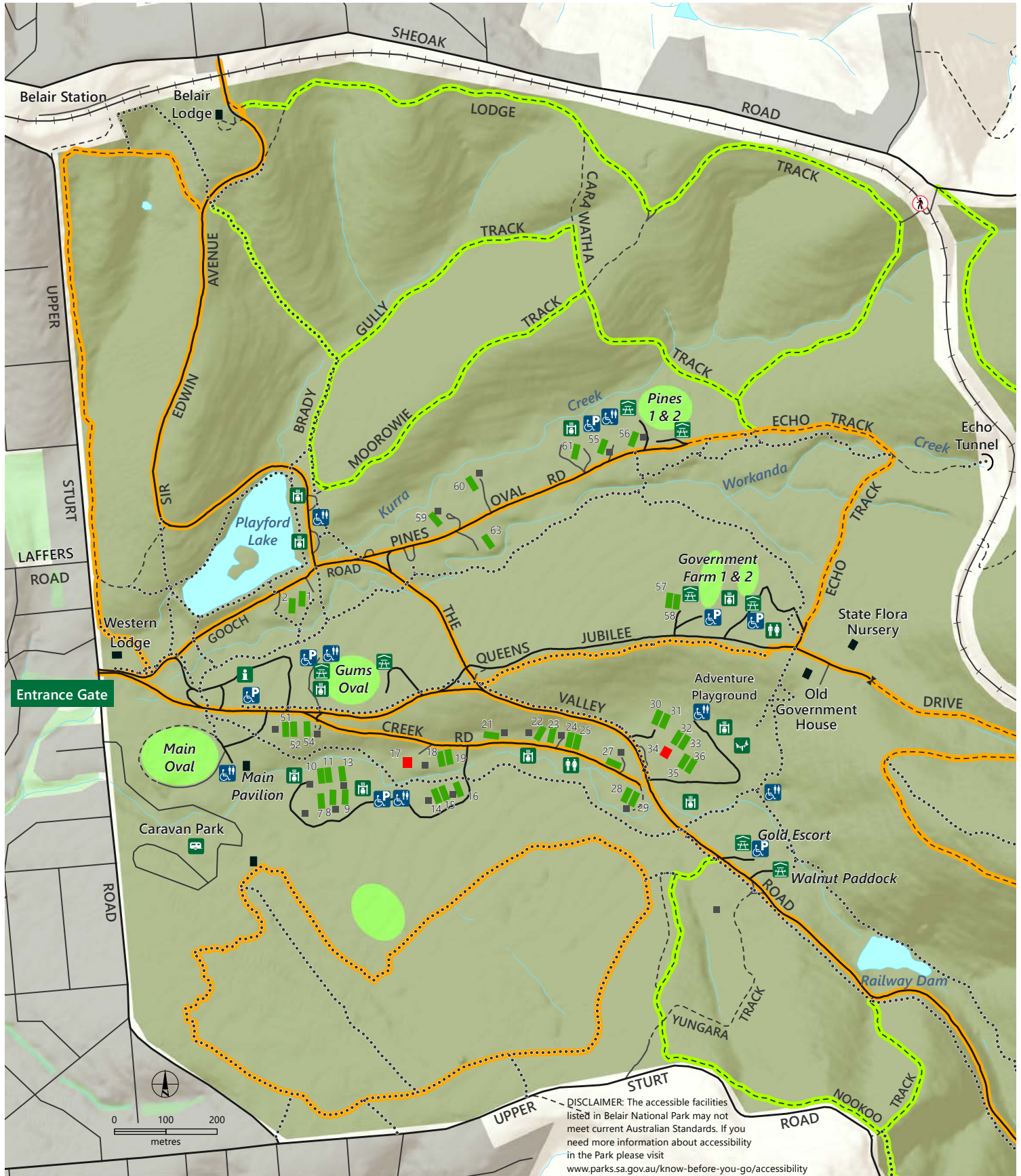

DISCLAIMER: The accessible facilities listed in Belair National Park may not meet current Australian Standards. If you need more information about accessibility in the Park please visit www.parks.sa.gov.au/know-before-you-go/accessibility

- | | | | | |
|------------------|--------------------|----------------------|-----------------------|--------------------|
| Park information | Toilets | Adventure playground | Sheltered picnic area | Accessible parking |
| BBQ facilities | Accessible toilets | Caravan park | No access | |

DEW does not guarantee that this map is error free. Use of the map is at the user's sole risk and the information contained on the map may be subject to change without notice. Cartography by DEW, Mapland - 2021

- | | | |
|---------------|--|--|
| Sealed road | Building; shelter | Shared use trail - walkers, cyclists, horses |
| Unsealed road | Tennis court/number; activity court/number | Shared use trail - walkers, cyclists |
| Track | Tunnel entrance; built-up area | |
| Trail | Belair National Park; hire facility | |
| Railway | Waterbody | |

Visit parks.sa.gov.au
Get the Avenza Maps app to use park maps on your phone.

For more information, contact:
Department for Environment and Water
E: parks@sa.gov.au
P: 08 8207 7700